

## Flux Power X48-G2 Installation Guide

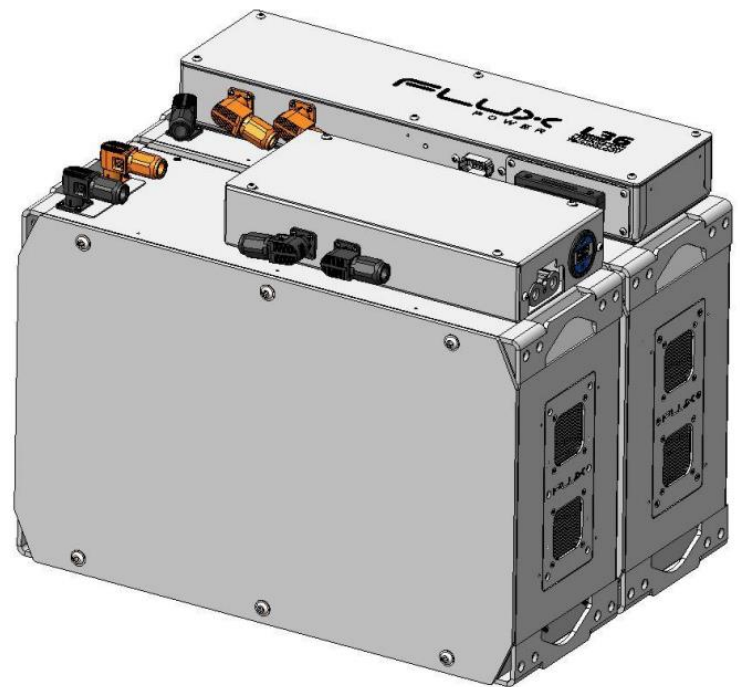

# Installation

## 1 Deliverables

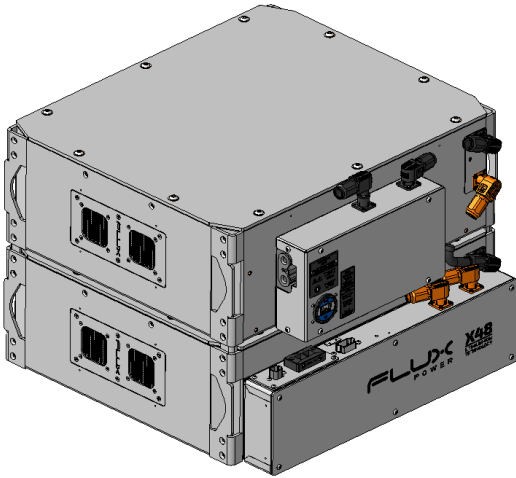

Battery  
QTY: 1

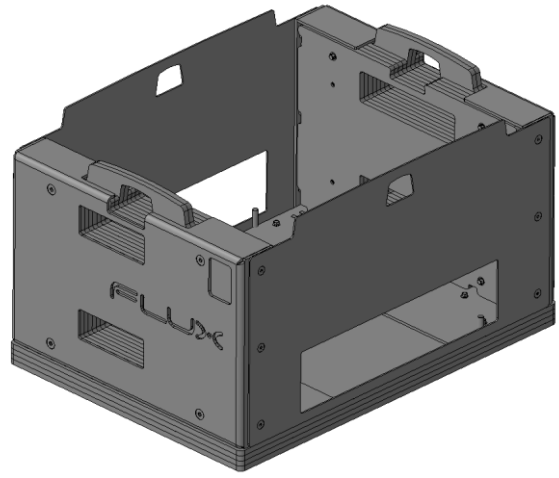

Weight Adapter  
Qty: 1

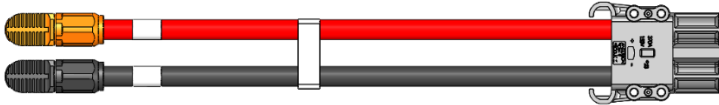

Power Cables (varying connector and length)  
QTY: 1

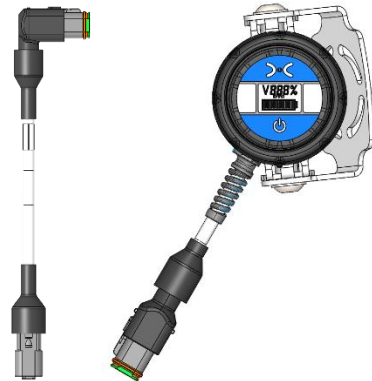

External BDI with Harness (if applicable)  
QTY: 1

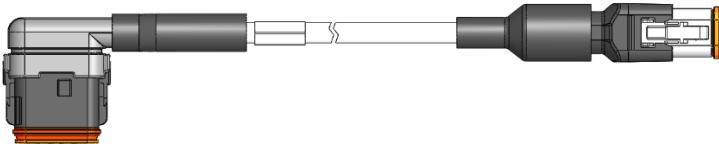

External Harness (varying connections and length)  
QTY: 1

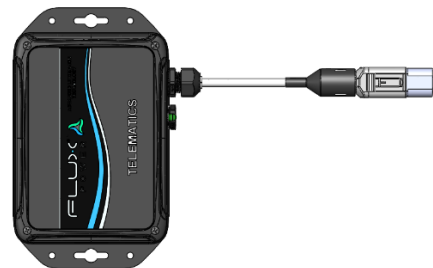

Telematics Box (if applicable)  
QTY: 1

# Installation



Lifting Ring  
QTY: 2

## 2 Battery Installation

### 2.1 Installing Power Cables

#### 2.1.1 Power Connections Between Battery Boxes

Each power connection will have a white label with a part number. If the battery arrives without the power connections properly connected, then connect them as shown. Power connection can only be inserted into receptacles of the same color and key. An orange insert will slide into an orange receptacle and a black insert into a black receptacle. Align the keys of the insert to that of the receptacle to properly insert the connection. A connector can also be removed by pressing on the button to the side of the plug and pulling the connector straight out.

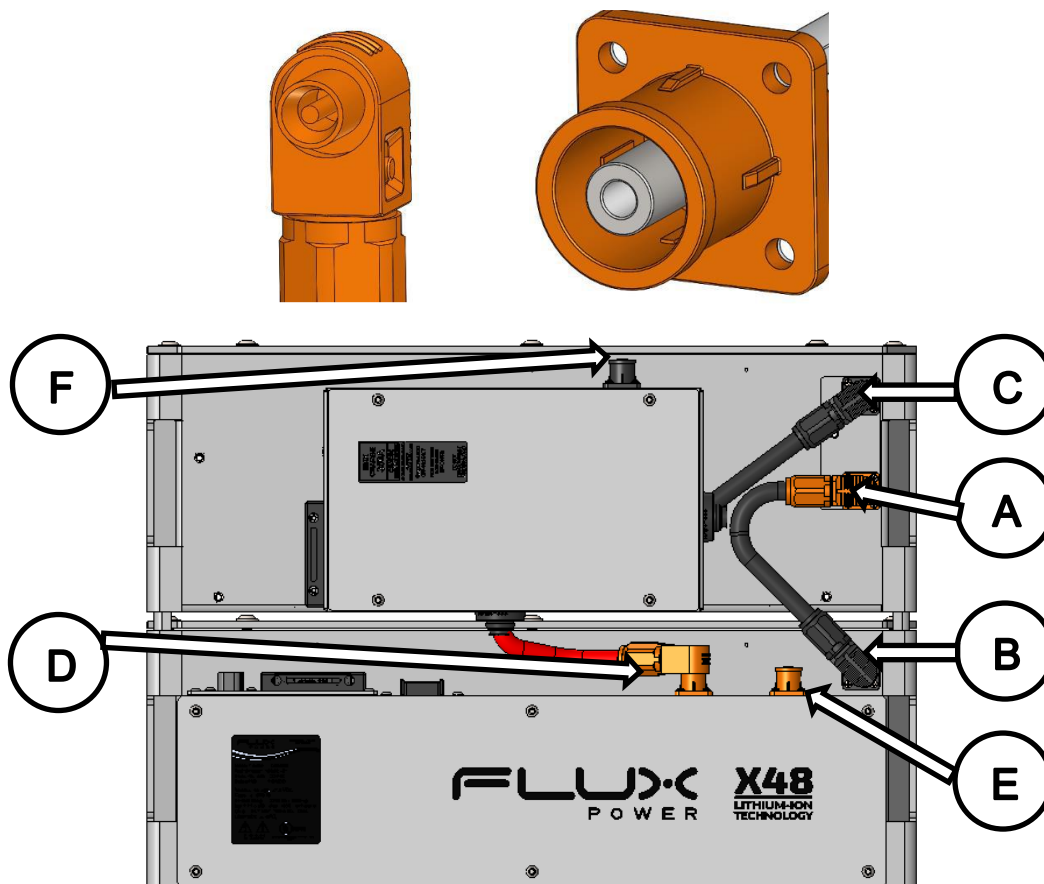

# Installation

Connection for cable 500650:

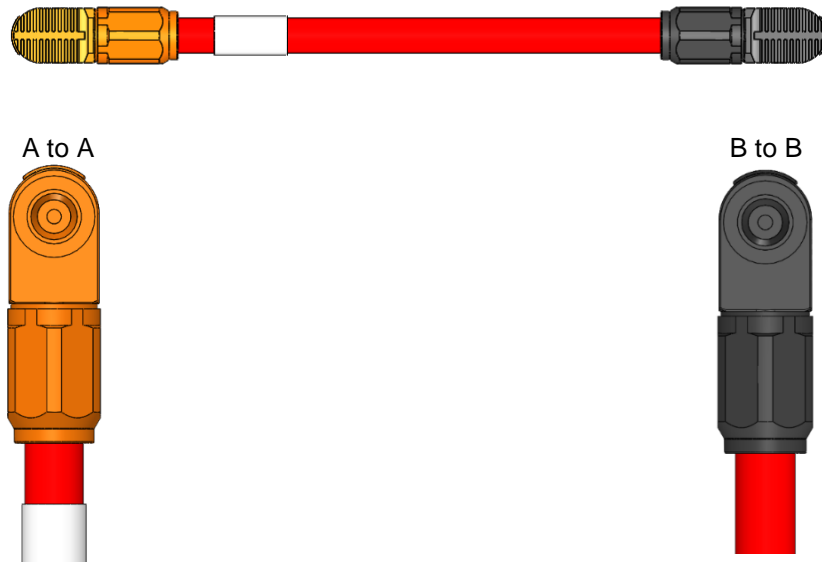

Connection for cable 500793:

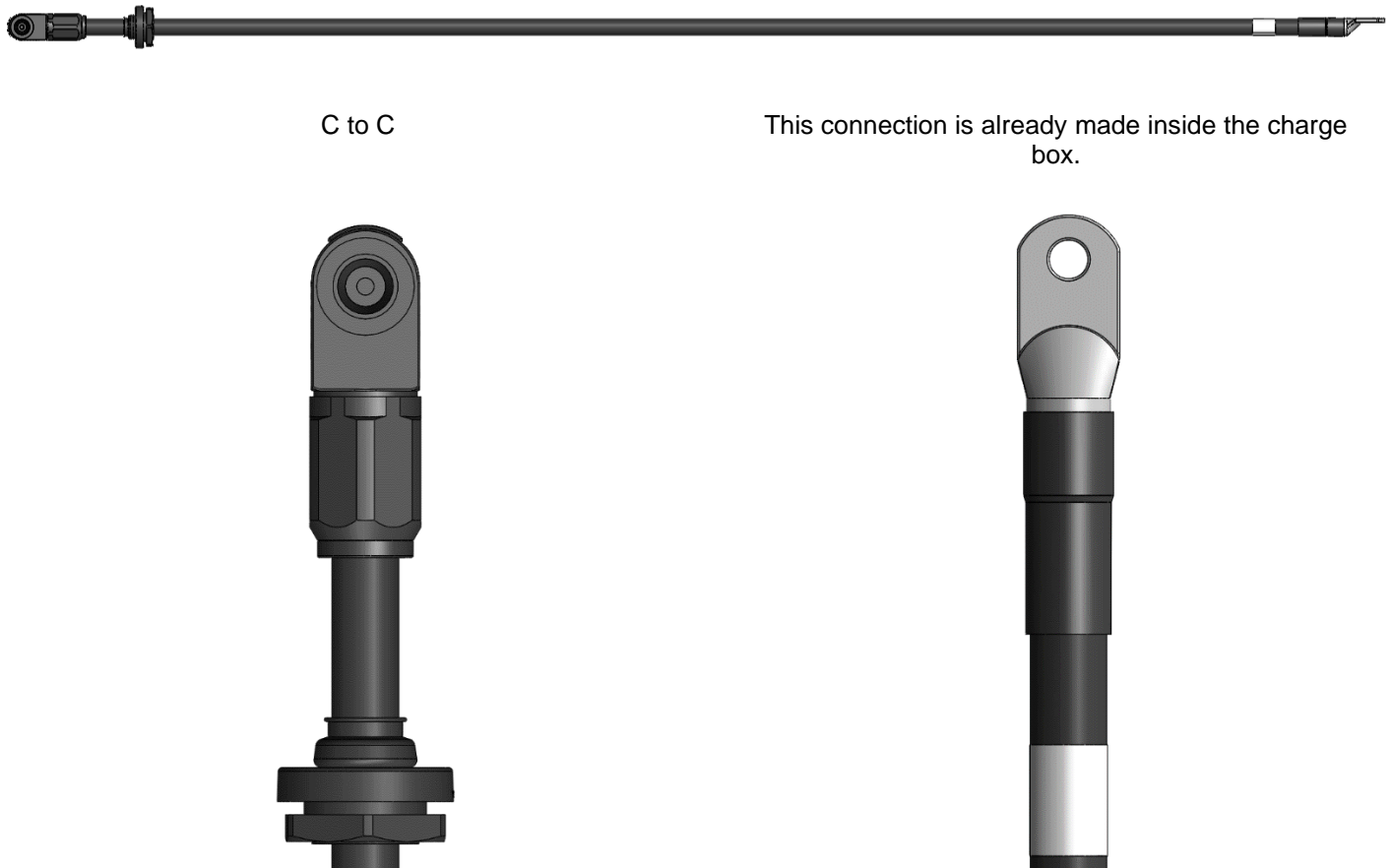

# Installation

Connection for cable 500651:



D to D

This connection is already made inside the charge box

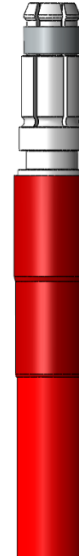
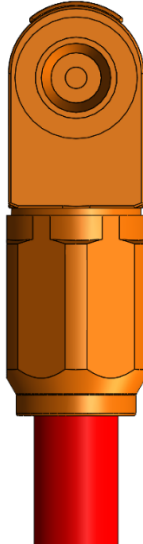

## 2.1.2 Discharge power cables

The discharge power cables have a connector complimentary to the connector on the truck.

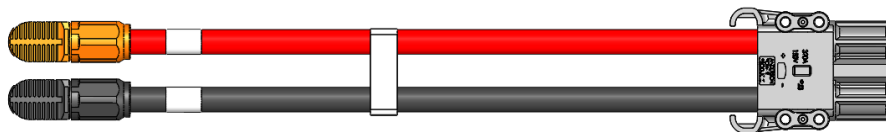

E to E

F to F

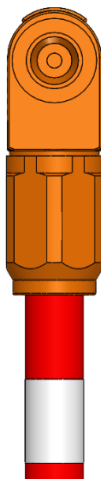

## 2.2 Installing Battery into Weight Adapter

### 2.2.1 Lifting Points

Installing the battery into the weight adapter will require the use of the lifting rings. The top face of the battery will have a total of 10 torque screws. Remove a set of screws opposite to each other to screw in the lifting rings. These two lifting rings are now the lifting points. A set of hooks with proper chains or lifting straps is recommended.

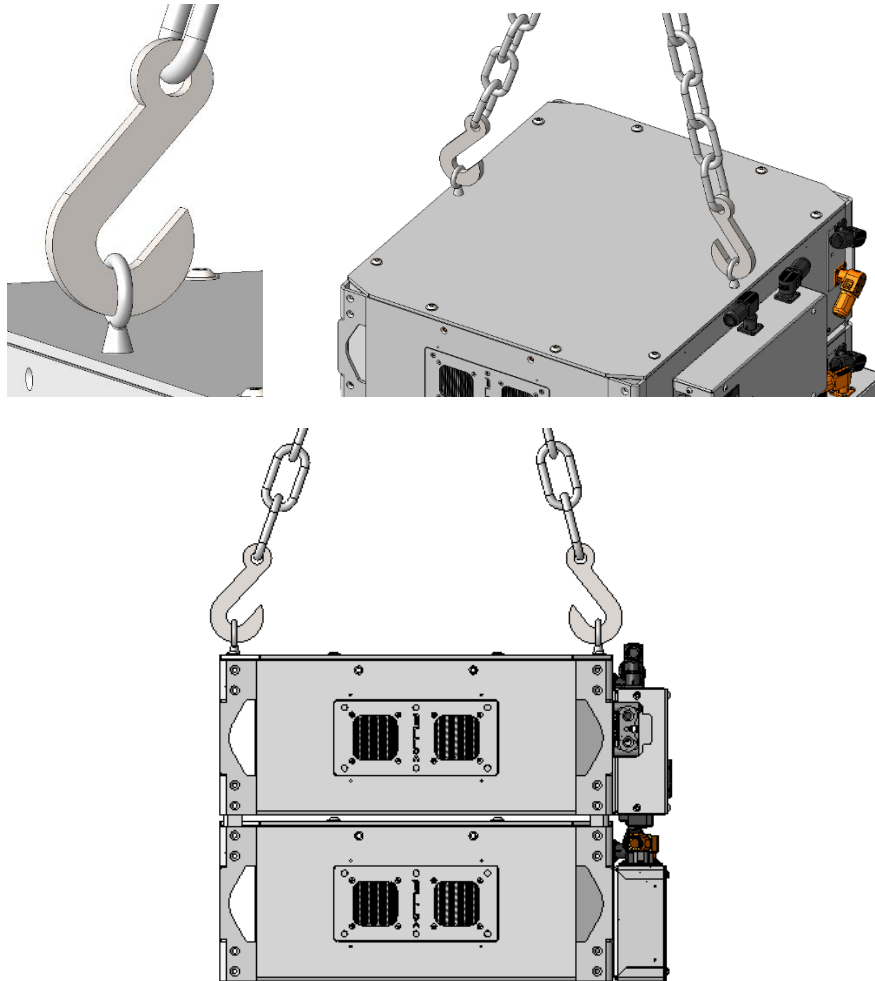

# Installation

## 2.2.2 Orientation

The battery should be oriented such that the electronics tray and the ventilation holes align properly with their respective slots on the weight adapter's sides.

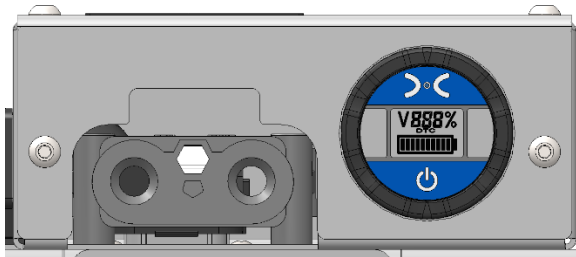

**FLUX**  
POWER

ADVANCED LITHIUM-ION  
TECHNOLOGY

fluxpower.com  
877-358-9487

**Combined Assembly**  
**Battery System and Truck Adapter**  
Service Weight: 2285 lbs / 1036 kg

Valid only with the following

**Battery System**  
Part Number: 100362-28  
Model Number: L36-840-G2  
Weight: 710 lbs / 322 kg

**Truck Adapter**  
Part Number: 200670-01  
Weight: 1575 lbs / 714 kg

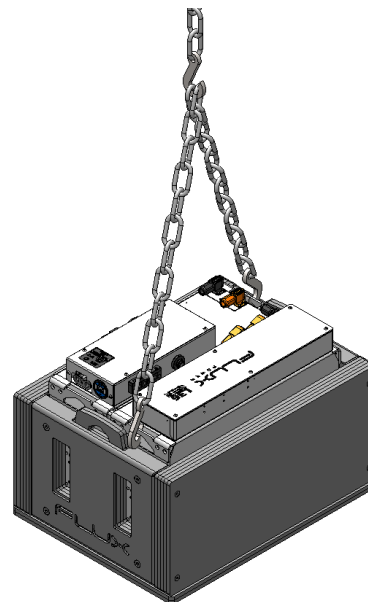
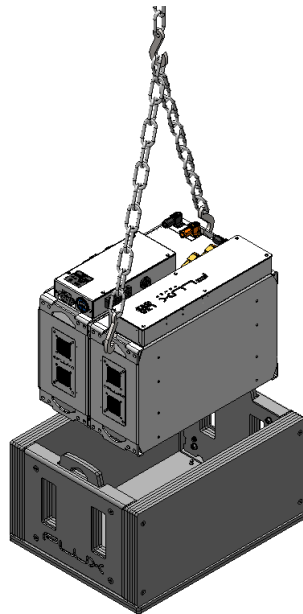
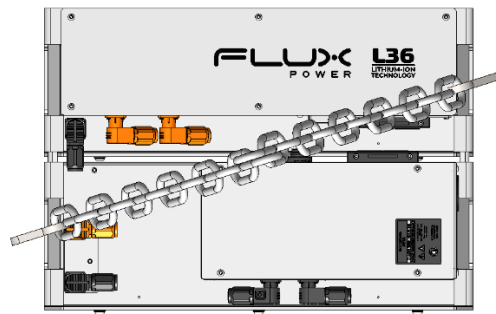

## 2.3 Installing Battery and Weight Adapter into Truck

### 2.3.1 Lifting Points

Use the two lifting points on the side of the weight adapter to lift the unit. Different weight adapters will have lifting points on different opposite sides. A set of hooks with proper chains or lifting straps is recommended.

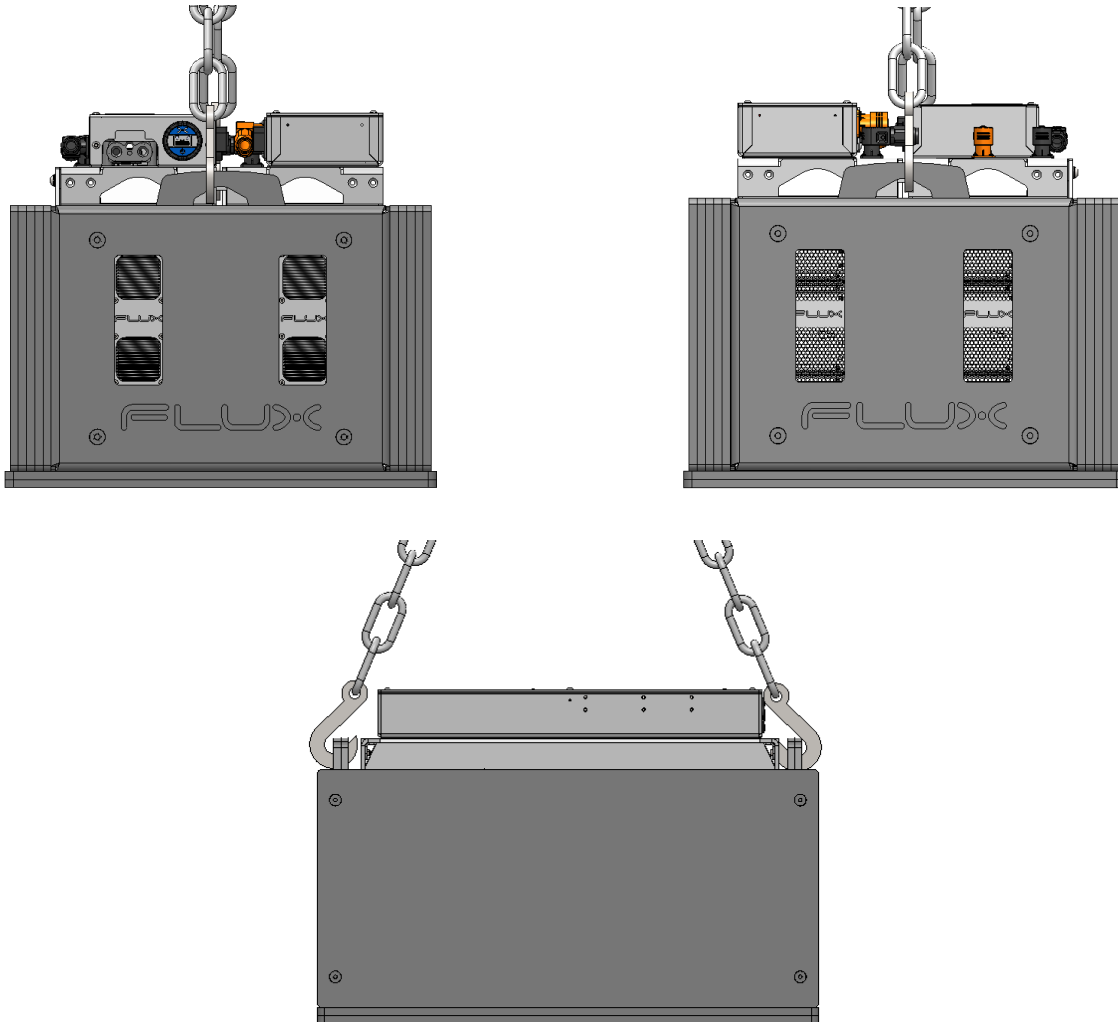



# Installation

## 2.3.2 Drop-in

Lift and align the battery into the truck's battery compartment by positioning the chain or straps through the gap of the truck's overhead guard. Tighten the truck gate and bumper if the battery compartment has adjustable stoppers present.

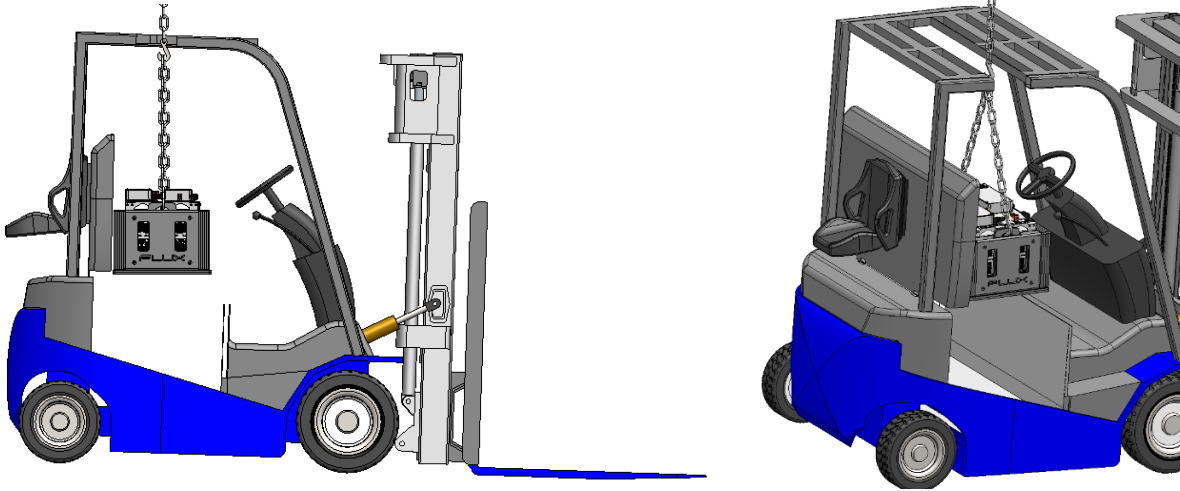

## 2.3.3 Slide-in

Sliding the battery into the compartment requires that both the battery and weight adapter be suspended in the air and then pushed into the compartment. The truck's battery compartment will have a sliding tray for the battery to slide in and out of the compartment. This may require one truck to suspend the loaded sliding tray in the air, and a second truck to push the loaded sliding tray back into the compartment. Pull the sliding tray out to place the unit on and then push the tray back into the compartment. Remove the lifting equipment prior to sliding the battery into the compartment.

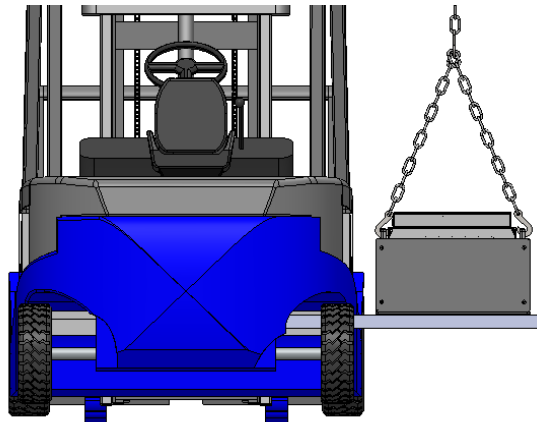

## 3 External Accessories Installation

### 3.1 External BDI (if applicable)

#### 3.1.1 Mounting Points

Use the magnets at the bottom of the mounting plate to mount to external BDI to the truck frame. Some mounting plates may have one or two magnets.

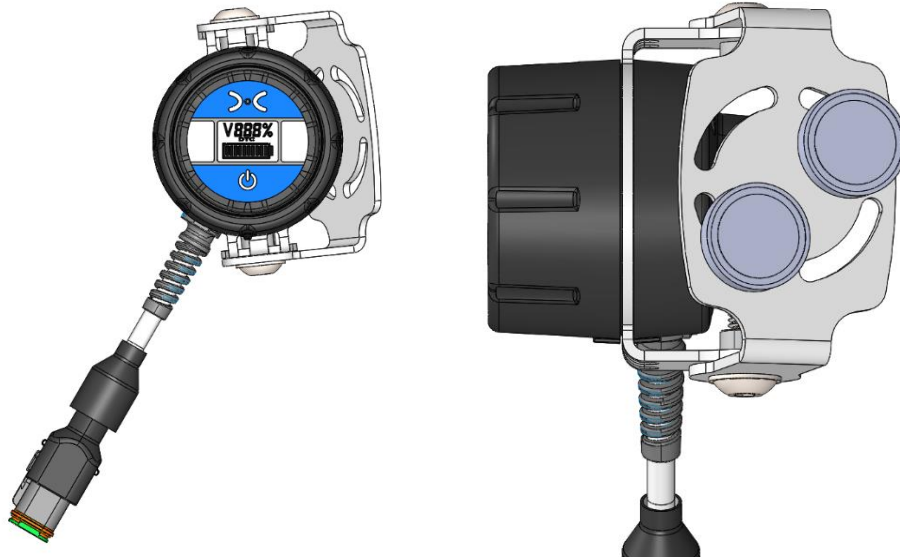

#### 3.1.2 Mounting Location

Mount external BDI so that it faces the operator with the Flux Power logo on top and the power button on the bottom.

The two button head screws on the sides of the mounting plate can be loosened to change the angle of the external BDI. Tighten the screws once the preferred orientation is reached.

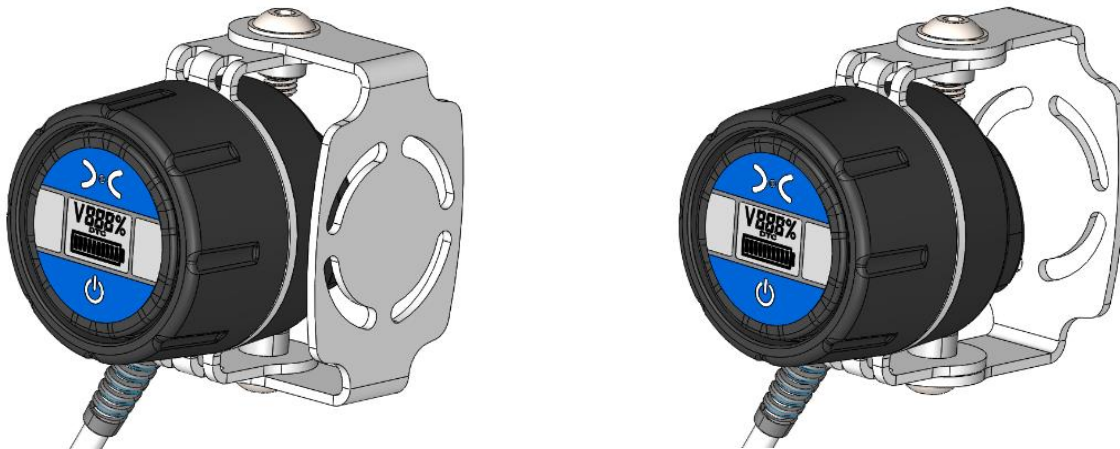

The three screws on the back of the BDI's housing can be removed to change the location of the secondary mounting plate of the external BDI.

# Installation

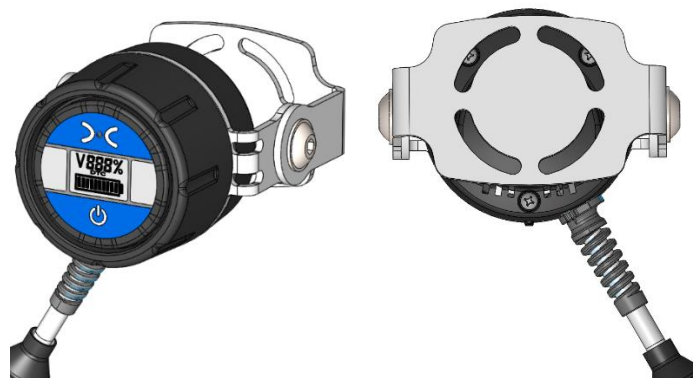
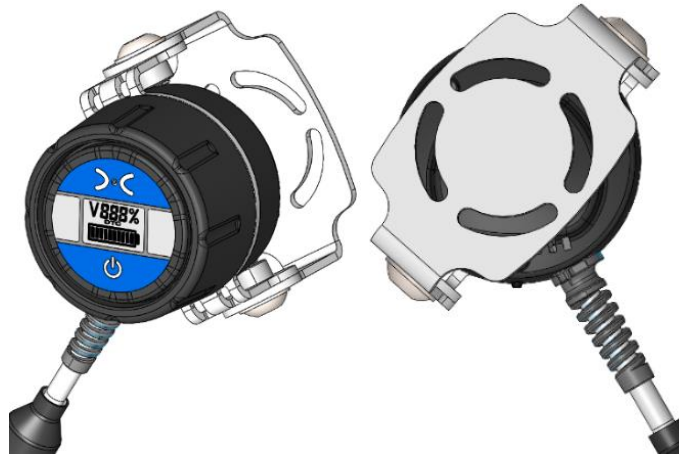
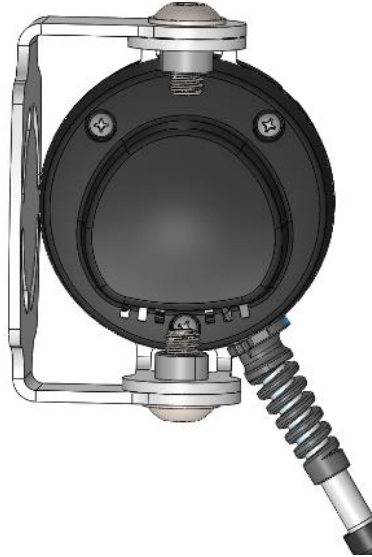

## 3.2 Telematics

### 3.2.1 Mounting Points

Use the 4 holes on the side to mount the telematics box onto the truck by tapping into the truck frame; or use the 2 slots on the side to zip-tie the telematics box onto the truck frame.



### 3.2.2 Mounting Location

Mount the telematics box underneath the overhead guard. Do not mount the telematics box underneath the driver's seat.

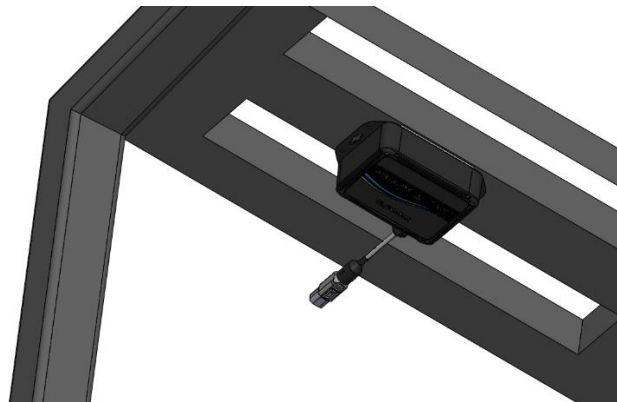

## 3.3 External Harness

### 3.3.1 Mounting Points

Use zip ties to mount the external harness's body along the truck frame. Different external harnesses have different connectors depending on the truck and the customer's order.

### 3.3.2 Mounting Location

Wrap the external harness within the inside of the truck frame to limit damage to the harness from the truck's surroundings. Recommended locations are highlighted stripped green. Areas to avoid are highlighted checkered red.

# Installation

Recommended locations in stripped green:

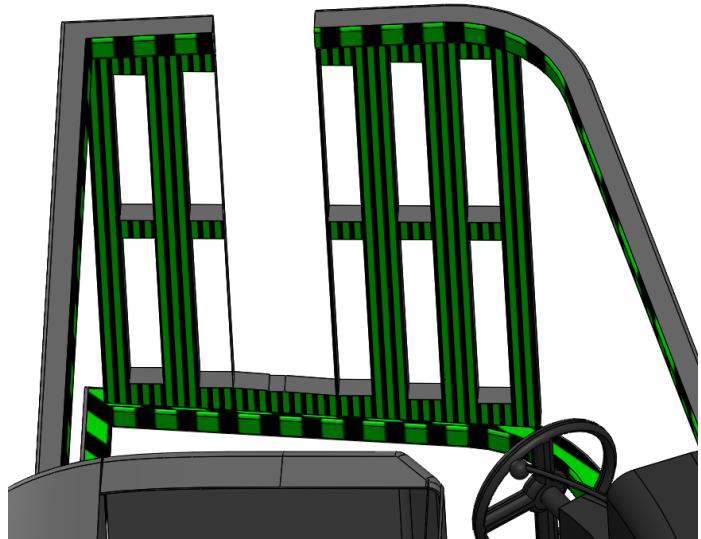
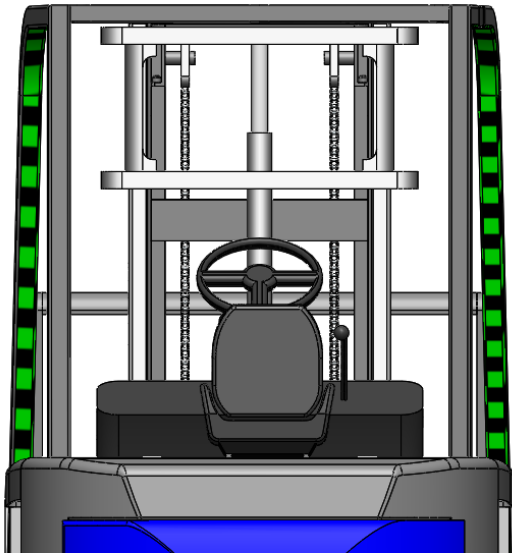
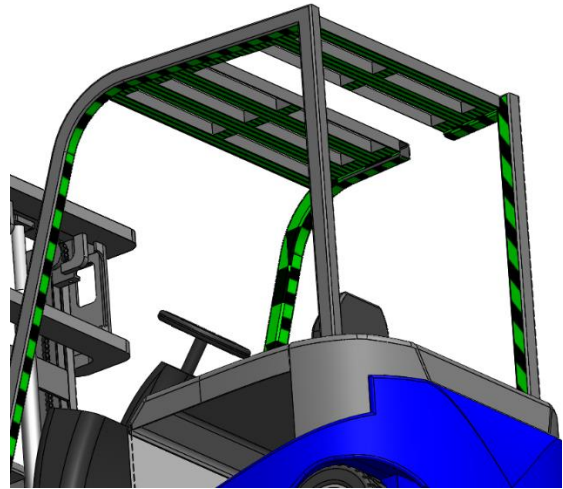
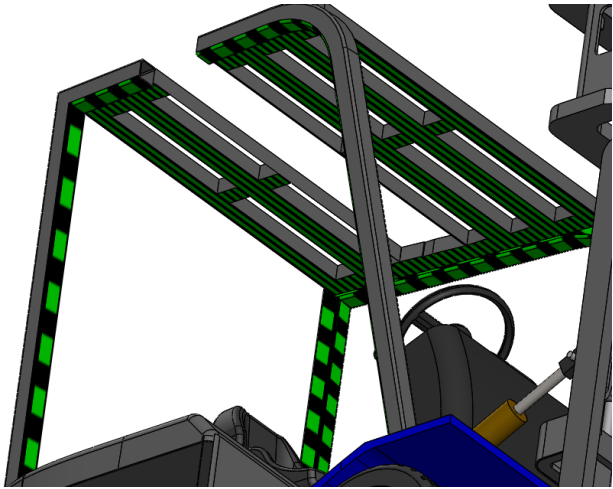



# Installation

Avoid mounting the harness in areas where it can be pinched or scraped. Areas to avoid in checkered red:

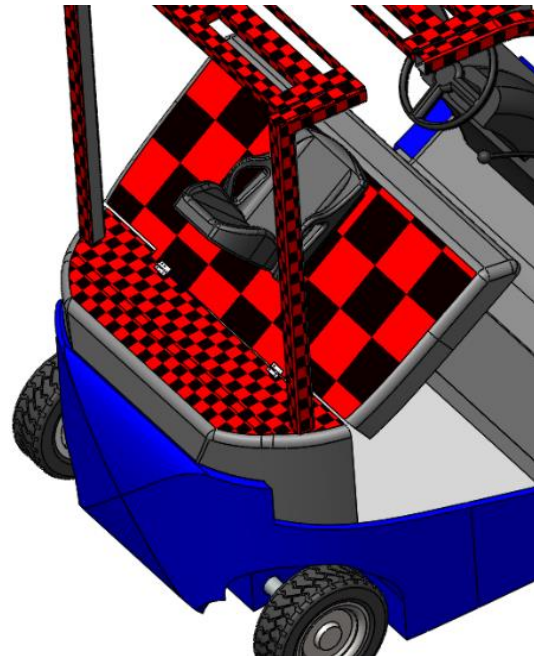
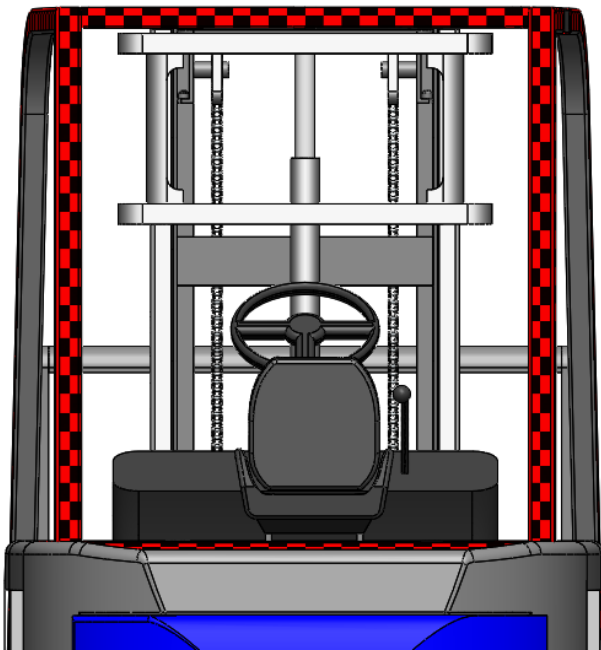
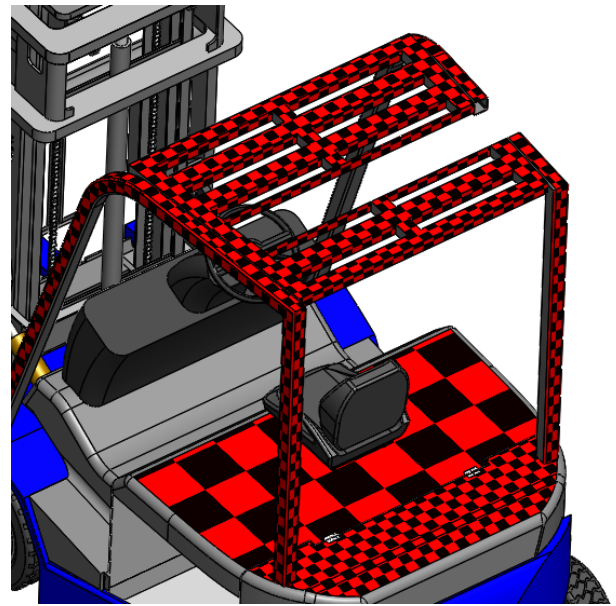
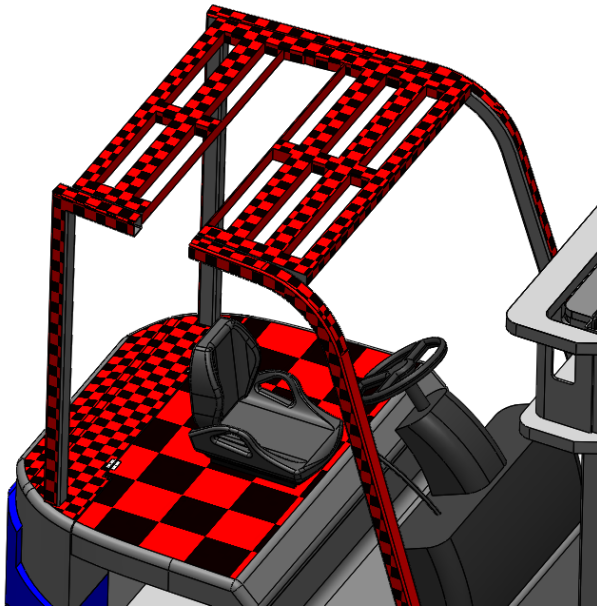

## 4 Operation

### 4.1 Discharging the Battery

The battery will need to have an external harness and all connectors properly connected to any external accessories present to discharge. External harness connections will vary between different harnesses and truck configurations. An external harness will either connect to the battery's 12-pin communications port, or to a 6-pin receptacle when an external BDI is present. The battery's power cables will have a complimentary connector to the truck. The power cables are always connected to the truck. Do not charge through the power cables.

An external harness connection to the 12-pin communications port's connection:

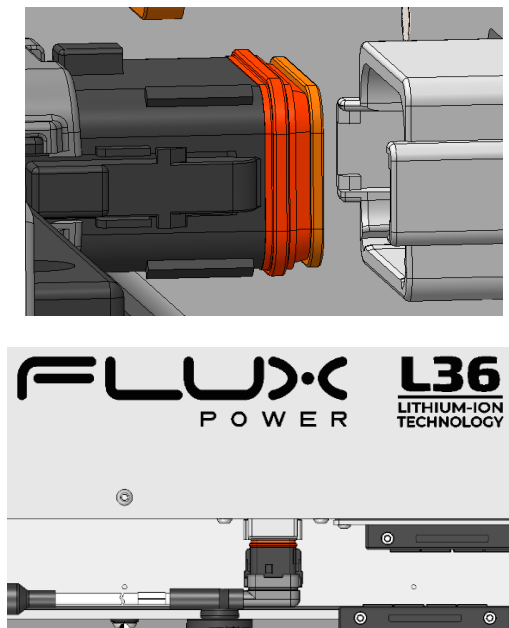

Telematics harness connection is a 4-pin connection:

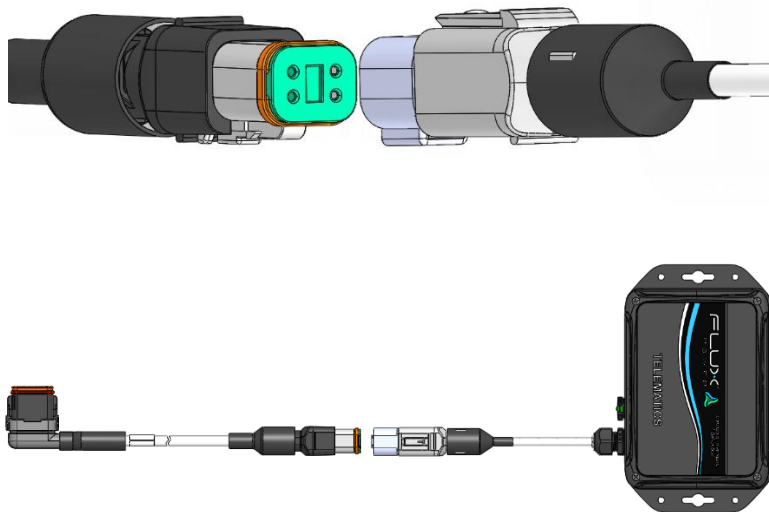

# Installation

External BDI connection is a 6-pin connection:

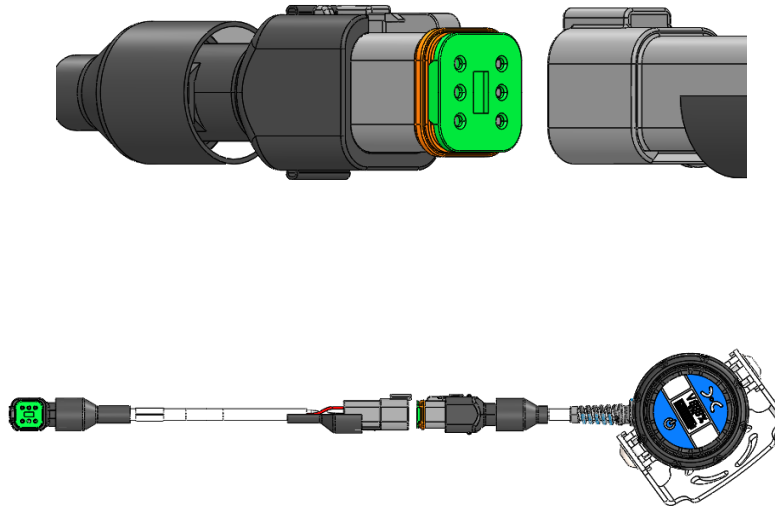

Depending on the battery configuration, it will either have an internal or external BDI. The internal and external BDI function the same way. The battery is turned ON by pressing and holding the power button symbol on the BDI for at least 3 seconds. The battery is turned OFF by pressing and holding the power button symbol for at least 3 seconds.

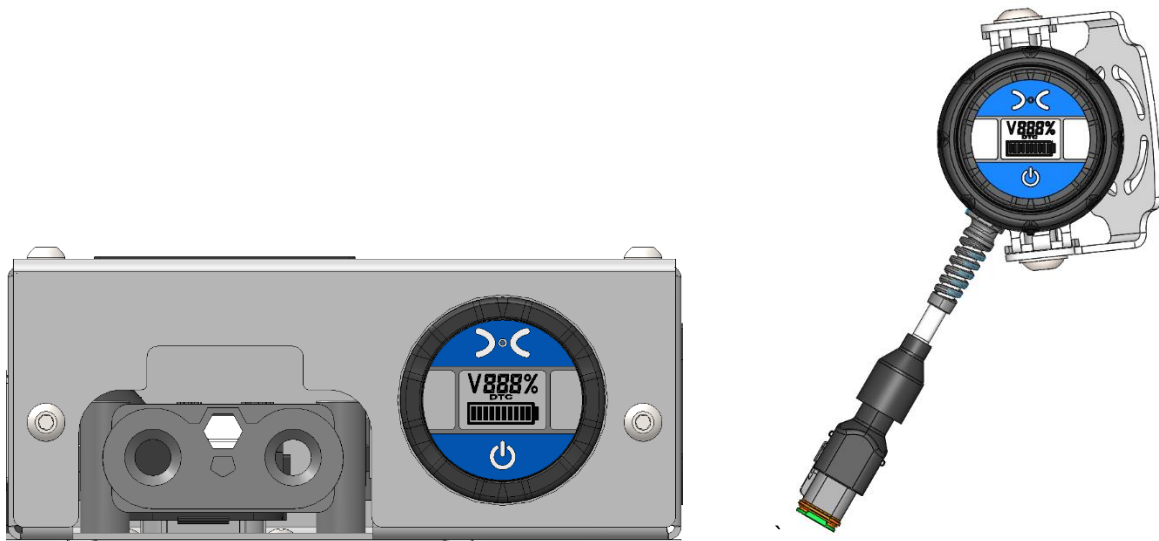



## 4.2 Charging the Battery

The battery's charge port will have a complimentary connector to the external charger. The connector will be an A320 connector, but some battery configurations may vary. The battery will cut power to the truck after 10 seconds of detecting a proper connection to the charger. Within those 10 seconds, the internal or external BDI of the battery will alarm.

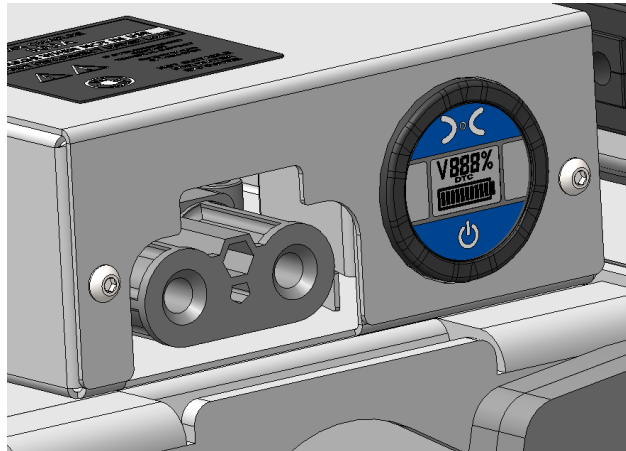

## 5 Flux Power Contact Details

Flux Power Inc.

Address: 2685 South Melrose Drive,  
Vista, CA 92081

Tel: 877-505-3589

Fax: 760-741-3535

Email: [Support@fluxpower.com](mailto:Support@fluxpower.com)

Web: [www.fluxpower.com](http://www.fluxpower.com)

**WARNING – Risk of Fire – No User Serviceable Parts**

Copyright © 2018 Flux Power, Inc. All rights reserved. Flux Power, the Flux Power Logo and Flux Power LiFT Pack are registered trademarks or trademarks of Flux Power, Inc. All other brands and product names are trademarks or registered trademarks of their respective owners. This information is intended for the use of Flux Power customers only. Any other use without the express written consent of Flux Power, Inc. is strictly prohibited